

For: File Resubmit Approval Other _____

M4860V2 5-ton Vertical Return Plenum Module

Job Name:	Location:
Date:	Tag #:
Architect:	Engineer:
Mechanical:	Distributor:
Rep:	

(Company)

(Project Manager)



M4860V2

Features

- Room for optional hot water coil with access from both sides
- Centrally located pleated filter
- Heavy-duty closed cell insulation (no exposed fiberglass insulation)
- Standard Unico System 'latch' system
- Includes secondary drain pan

Matching Modules

M4860BL1-EC1/EC2
M4860CL1-B
M4860CL1-E
M4860CL1-C
M4860CL1-H

Indoor Unit Size

4860

General Data:

Dimensions (H x W x D)	18.25 x 38 x 17.5 in. (464 x 965 x 445 mm)
Total Return Opening	254 in ² (0.16 m ²)
Equivalent Return Opening Diameter	18 in (457 mm)
Filter Size	Filter 1: 18 in x 20 in x 1 in (457 mm x 508 mm) Filter 2: 18 in x 18 in x 1 in (457 mm x 475 mm)
Maximum Airflow	1250 CFM (590 L/s)
Maximum Velocity	350 FPM (1.78 m/s)
Initial Resistance	0.4 in. w.g (100 Pa)
Drain Pan Dimensions	29.13 x 41.13 x 1.5 in. (740 x 1045 x 38 mm)
Drain Pan Fitting	3/4" Socket x 3/4" MPT, SCH 40 PVC

Optional Accessories

- Hot water coil (HW-4860)
- Modular Variable Speed Air Handler (M4860BL1-EC*)
- Return adapter (UPC-104-4860)

Notes:

1. Refer to installation manual for more information.

Model Number Key:

M	4860	V	2	1
Model Series	Matching ODU Nominal Capacity	Module Type	Revision	Options
M = Modular	4860 = 48000 to 60000 Btu/hr	V = Vertical Return Plenum		1 = Paint White

M4860V2

Job Name:

Location:

Date:

Tag #:

RETURN AIR PLENUM MODULE DIMENSIONS

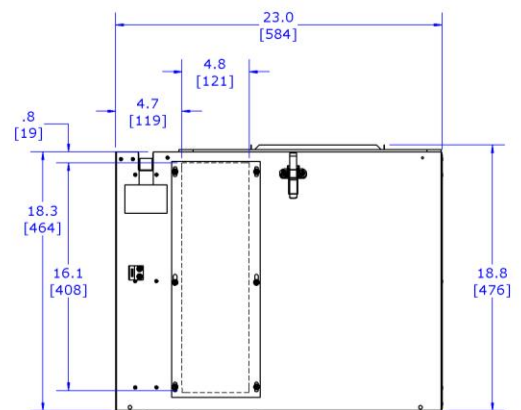
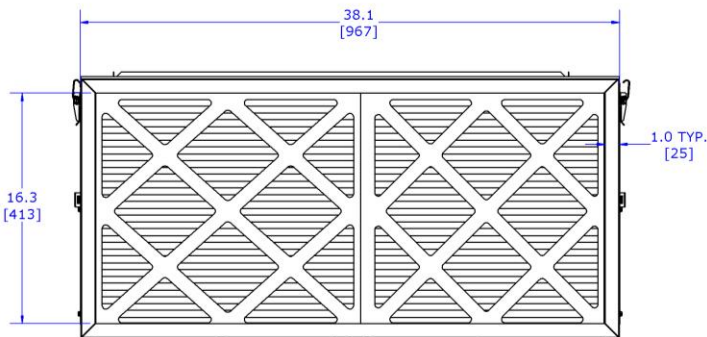
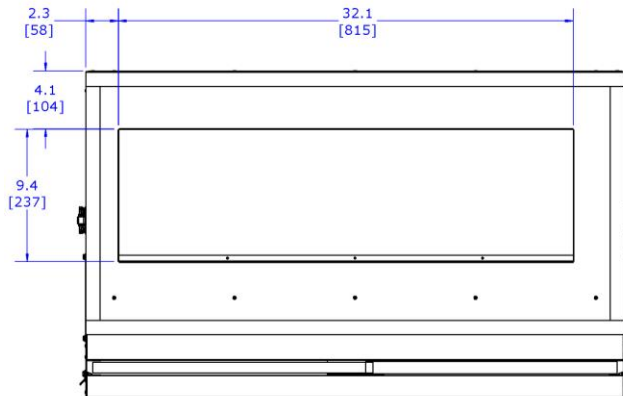

* Contact Unico for dimensions of assembled modules.

Installation Clearances

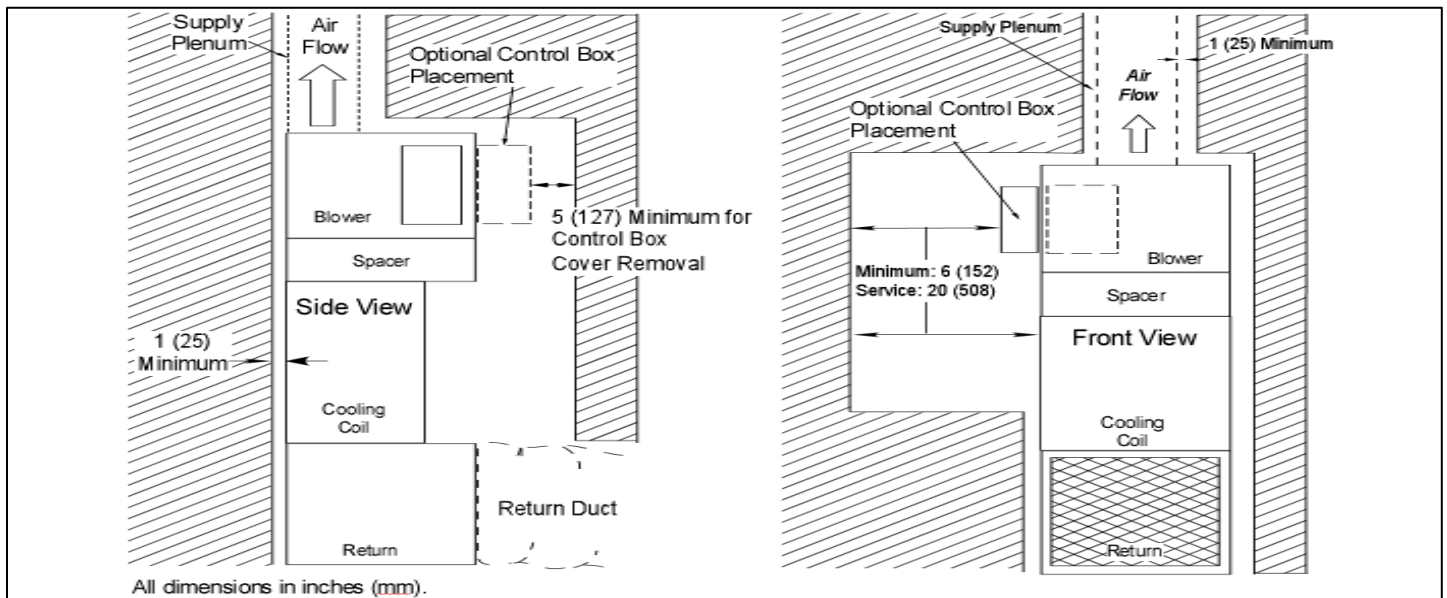

Unico, Inc.
<http://tech.unicosystem.com>
 314-481-9000
 800-527-0896
sales@unicosystem.com

